

**ST S**

**SLIP ON FLANGES**

**ANSI ASTM B16.5 A105**

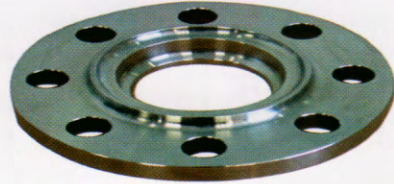
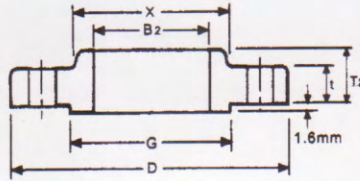

150LBS

IN.MM

Size	Raised face	Base Of hub	thick	Thru. hub	Dia.of Bolt	No. of holes	Dia.of Bolt	Approx Weight		
	D	G	X	t	B2	T2	Circle	Holes		
	In	In	In	In	In	In	In	In		
DN	mm	mm	mm	mm	mm	mm	mm	mm		
								Pounds		
								KG		
½"	3.5	1.38	1.19	0.44	0.88	1.62	2.38	4	0.62	0.9
	88.9	35.1	30.2	11.2	22.2	15.7	60.30		16.00	0.39
¾"	3.88	1.69	1.5	0.5	1.09	0.62	2.75	4	0.62	1.2
	98.6	42.9	38.1	12.7	27.8	15.7	69.80		16.00	0.56
1"	4.25	2	1.94	0.56	1.36	0.69	3.12	4	0.62	1.7
	108	50.8	49.2	14.2	34.5	17.5	79.40		16.00	0.78
1 ¼"	4.62	2.5	2.31	0.62	1.7	0.81	3.50	4	0.62	2.3
	117.3	63.5	58.7	15.7	43.2	20.6	88.90		16.00	1.03
1 ½"	5	2.88	2.56	0.69	1.95	0.88	3.88	4	0.62	2.9
	127	73.2	65.1	17.5	49.5	22.4	98.40		16.00	1.32
2"	6	3.62	3.06	0.75	2.44	1	4.75	4	0.75	4.5
	152.4	91.9	77.6	19.1	61.9	25.4	120.60		20.00	2.06
2 ½"	7	4.12	3.56	0.88	2.94	1.12	5.50	4	0.75	7.2
	177.8	104.6	90.5	22.4	74.6	28.4	139.70		20.00	3.28
3"	7.5	5	4.25	0.94	3.57	1.19	6.00	4	0.75	8.5
	190.5	127	107.9	23.9	90.7	30.2	152.4		20.00	3.85
3 ½"	8.5	5.5	4.81	0.94	4.07	1.25	7.00	8	0.75	10.6
	215.9	139.7	122.2	23.9	103.4	31.8	177.80		20.00	4.81
4"	9	6.19	5.31	0.94	4.57	1.31	7.50	8	0.75	11.7
	228.6	157.2	134.9	23.9	116.1	33.3	190.5		20.00	5.3
5"	10	7.31	6.44	0.94	5.66	1.44	8.50	8	0.88	13.4
	254	185.7	163.5	23.9	143.7	36.6	215.9		23.00	6.07
6"	11	8.5	7.56	1	6.72	1.56	9.50	8	0.88	16.4
	279.4	215.9	192.1	25.4	170.7	39.6	241.3		23.00	7.45
8"	13.5	10.62	9.69	1.12	8.72	1.75	11.75	8	0.88	26.7
	342.9	269.7	246.1	28.4	221.5	44.5	298.4		23.00	12.1
10"	16	12.75	12	1.19	10.88	1.94	14.25	12	1.00	36.3
	406.4	323.8	304.8	30.2	276.2	49.3	361.9		26.00	16.5
12"	19	15	14.38	1.25	12.88	2.19	17.00	12	1.00	57.7
	482.6	381	365.1	31.8	327	55.6	431.8		26.00	26.2
14"	21	16.25	15.75	1.38	14.14	2.25	18.75	12	1.12	76.2
	533.4	412.8	400	35.1	359.2	57.2	476.2		29.00	34.6
16"	23.5	18.5	18	1.44	16.16	2.5	21.25	16	1.12	98.7
	595	469.9	457.2	36.6	410.4	63.5	539.7		29.00	44.8
18"	25	21	19.88	1.56	18.18	2.69	22.75	16	1.25	108
	635	533.4	504.8	39.6	461.8	68.3	577.9		32.00	48.9
20"	27.5	23	22	1.69	20.2	2.88	25.00	20	1.25	136
	698.5	584.2	558.8	42.9	513.1	73.2	635		32.00	61.9
24"	32	27.75	26.12	1.88	24.25	3.25	29.50	20	1.38	191
	812.8	692.2	633.6	47.8	615.9	82.6	749.3		35	86.9